

Project Name: Family Room Upgrade
Residential Interior Element under \$30,000
Completion Date: April 29, 2022
Location: DeForest, WI

NARI CotY
WINNER OF
MULTIPLE AWARDS

degnan
DESIGN·BUILD·REMODEL

RESIDENTIAL INTERIOR ELEMENT
DEFOREST, WI
2022



These clients came to us looking for design solutions. They needed serious improvement for a laundry room and minuscule entry from the garage. The back entry dedicated a quarter of its space to a hallway, but the hallway was not large enough to allow a mudroom. It was just wasted space.



BEFORE: VIEW OF LAUNDRY

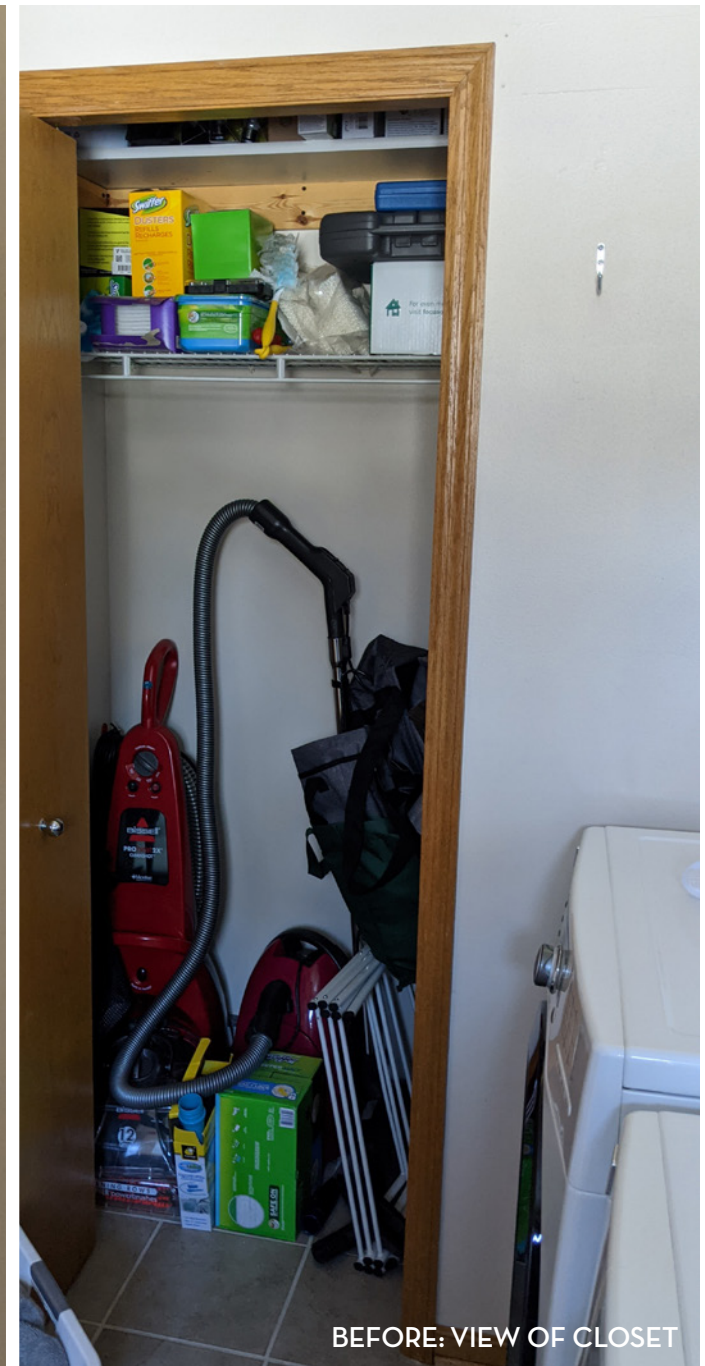

BEFORE: VIEW OF CLOSET

The laundry room was dilapidated and had only a small closet with a bifold door that made it even more obstructed.



The solution was to open the laundry room to the hallway, and make it something beautiful so that even when you walk by the laundry room to reach the powder room, it is more of statement piece, rather than a cluttered mess.



BEFORE: CLUTTERED LAUNDRY

AFTER



AFTER: VIEW OF NEW BENCH

A pocket door (not shown), bifold door, and two walls of the closet were removed. Now, in place of the closet sits a customized bench with shoe cubbies, coat hanging space, and cabinet doors to store away gloves, hats and other seasonal items.



BEFORE: BIFOLD CLOSET



AFTER: CLOTHES HANGING WITH STORAGE ABOVE

The laundry room is now bright and cheerful, with plenty of cabinetry, drawers, pullouts and doors.



AFTER: DRAWERS FOR STORAGE



AFTER: HOOKS FOR ADDITIONAL HANGING SPACE

There is a designated cabinet to store the vacuum cleaner and other cleaning supplies that were formerly housed in what should have been the coat closet. Also important to the clients was a fold-out drying rack (shown on next page) so that clothes can be left to hang dry.

CONCEPT DRAWINGS

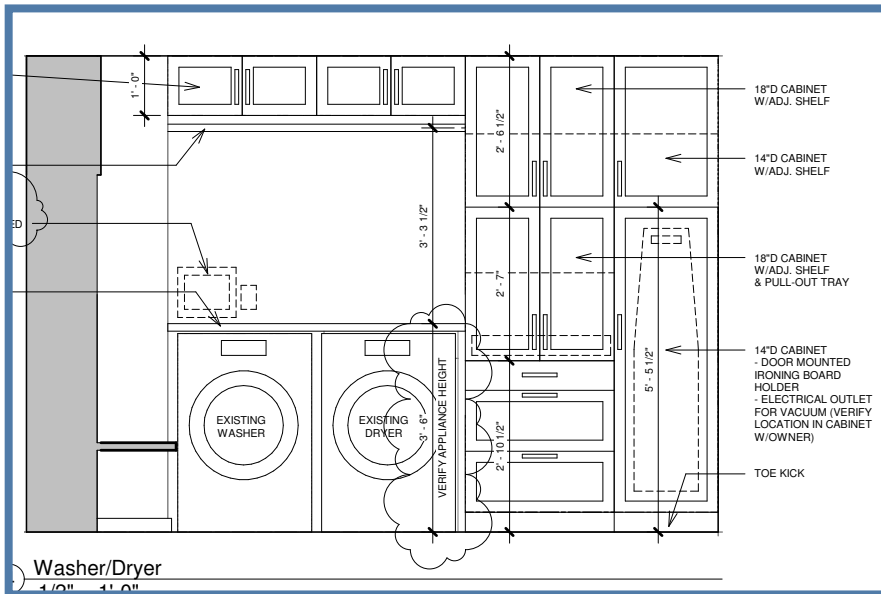

AFTER

AFTER



Cabinets of varying depths have been used in order to accommodate the large front window, newly replaced. Every bit of storage, every bit of space, and all of the daily functions have been carefully evaluated and laid out in order to make this laundry room and entryway perfect.





CRITERIA RESPONSES

To what degree were the expressed needs of the client met?

We met all of the following needs in our project. The needs included:

- a known limitation was the washer and dryer needed to be side by side, not stacked.
- a known concern is that all of the storage out in the open currently gets dusty and linty.
- the laundry room needed to be brighter.
- allow for hanging space to air-dry laundry.
- create storage for mops, vacuum cleaner and ironing board.
- additionally, try to free up the current closet in order to create coat storage. Consider if there is any way to make the area work more like a mudroom/laundry room combination.

To what degree does the project enhance the existing structures functionally?

The laundry room and mudroom remodeling was totally focused on function! The cabinetry needs were all specifically designed to provide the type of storage the clients wanted. We talked with them about exactly what they expected to store in every drawer and behind every door, and sized things accordingly. We provided the space to hang laundry, and ensured that there was space for all their needs. In this case, the solution to better storage was removal of the closet. We eliminated a dysfunctional closet that was full of wasted space (wall thickness, door size, etc.) and created the perfect bespoke bench, shoe cubby, and coat hanging space that opens the room for better functionality. Awareness of our design capabilities and the efficiency of our cabinetmakers made a mudroom work, with storage innovations instead of a standard closet. Finally, the window was preserved to provide light to the entire back entry of the home.

To what degree does the project enhance the structure aesthetically?

Aesthetics of the entire laundry room have been improved dramatically thanks to the new design. The painted cabinetry will be durable for years to come, which is a key part of the aesthetics. The color is perfectly integrated with the existing tile floor, and the comfortable Earl Gray color helps everything feel cool and bright. Everything has its place behind closed doors.

Is there evidence of superior craftsmanship?

With such a tight laundry room and so much to be done there, every fraction of an inch counts. Careful measurement, planning, design, fabrication and installation of the cabinetry was necessary to take advantage of all the space, particularly fitting carefully to the window in the narrow room.



CRITERIA RESPONSES

Were innovative uses of material and/or methods of construction used in the project?

Creating the cabinetry layout to provide the perfect storage for our clients is a key innovation in this project.

Did the contractor overcome difficult obstacles?

The client had extra floor tile that we were able to use to patch the areas that were now exposed due to the closet being removed. Through careful demo work, and careful patching and matching of the grout, we were able to achieve seamless results.