

A ROOM WITH A VIEW



 *degnan*
DESIGN·BUILD·REMODEL

A DESIGN DILEMMA

Our clients wanted to add a screen porch to this home, but not just your typical porch: one that was interesting and above all preserved the view of the woods from the rooms in the home.

PRESERVING THE VIEW

- *high vision screen*
- *glass balusters*
- *cable rail*

EXTENDING THE OCTAGON

- *unique roof design*
- *custom ceiling plan with space for a ceiling fan*
- *matching deck lines*
- *superior craftsmanship installing deck boards*

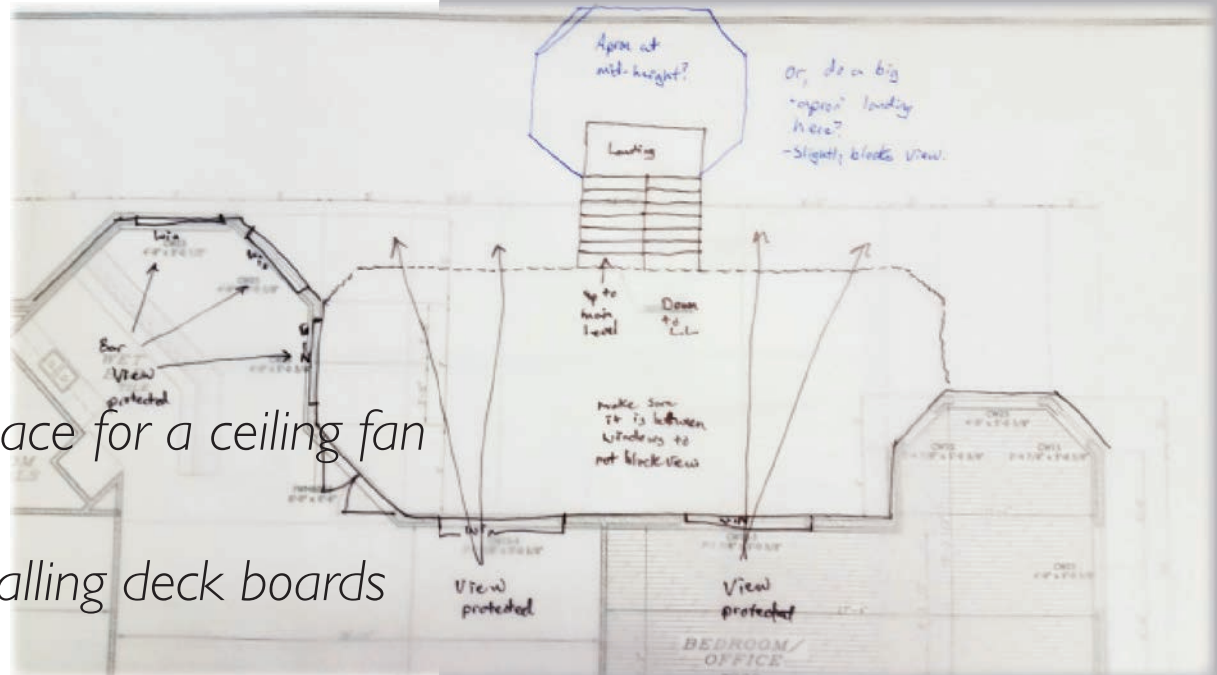

DESIGN DILEMMA #1



PRESERVING THE VIEW



PRESERVING THE VIEW

CABLE RAIL



HIGH DEFINITION SCREEN

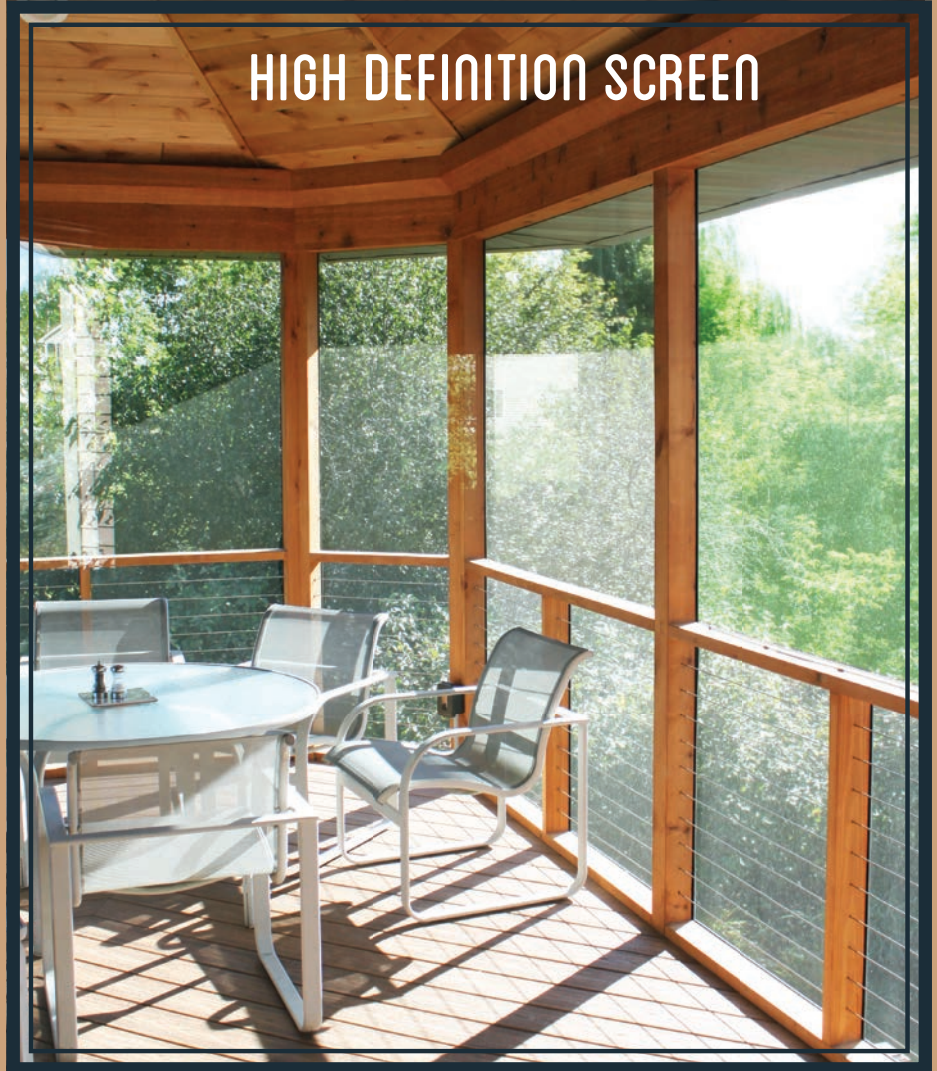

GLASS BALUSTERS

PRESERVING THE VIEW



PRESERVING THE VIEW

VIEW FROM DINING ROOM



VIEW FROM OFFICE



A big part of preserving the view was making choices about room placement, column placement, and the space needed for stairway access.

BEFORE



The addition and stairs were placed to minimize the impact on the office and living room views. The room was placed off the dining room, using high-visibility materials, to preserve that view but also to let the clients enjoy the view of the craftsmanship itself.



WE ADDED SOME STAIRS



WHERE THERE WERE NONE



GRANTING ACCESS TO THE YARD



DESIGN DILEMMA #2

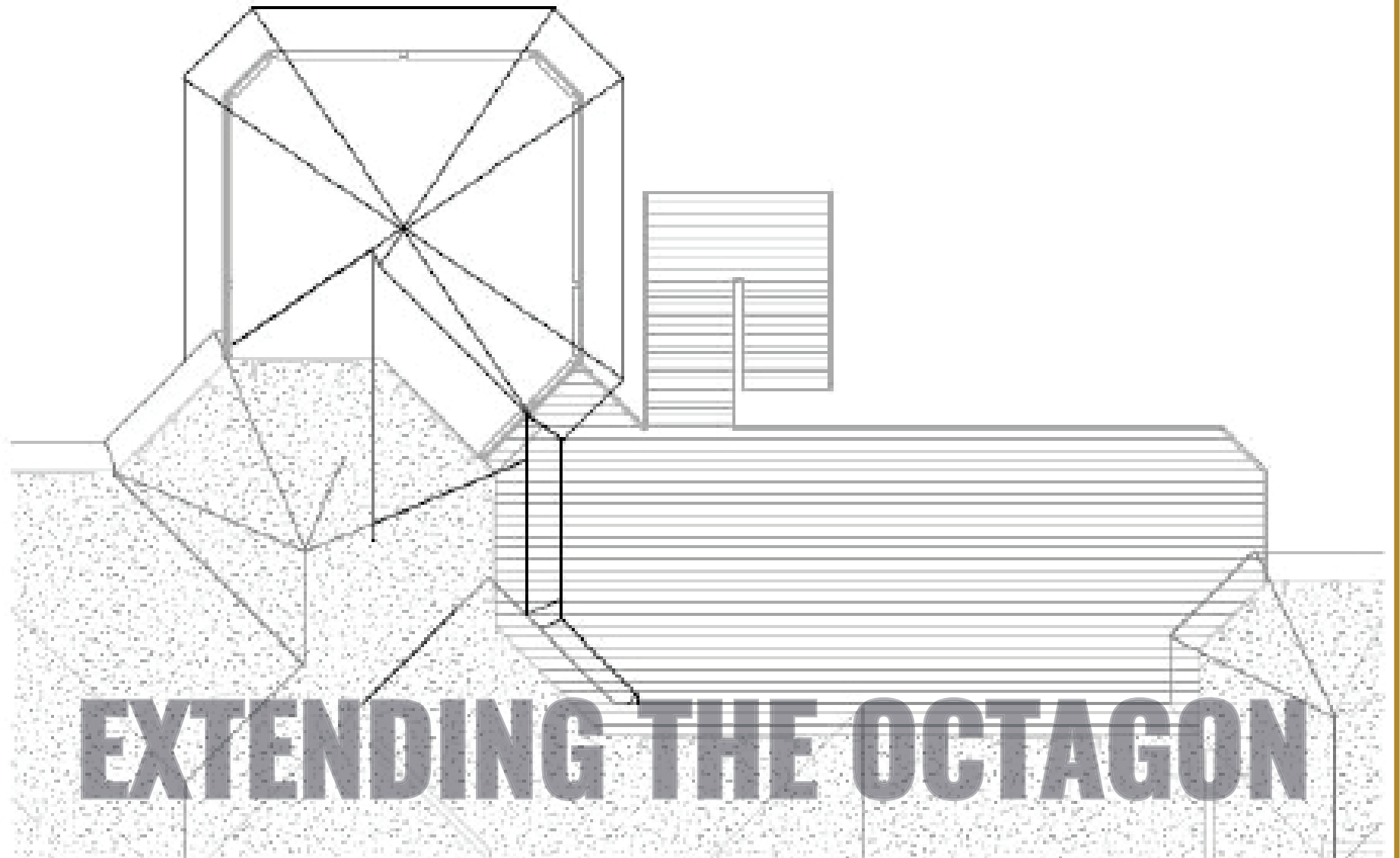

EXTENDING THE OCTAGON

EXTENDING THE OCTAGON

IN PROGRESS

We often think about octagons as symmetrical. Ours happens to be irregular as it ties into the house. The cathedral ceiling takes on its own shape as it rises gracefully and ties in to the tall wall of the existing house.



$$A = 4 \sin \frac{\pi}{4} R^2 = 2\sqrt{2}R^2 \simeq 2.828 R^2$$









We even explored half a dozen different decking layouts for the new room before choosing one that follows the shape of the original house.



NO JOB IS WITHOUT ITS CHALLENGES



Due to schedules and availability of rental equipment combined with a deep winter frost, it was necessary to heat the ground by using charcoal in order to expedite the beginning of construction.





BEFORE



AFTER



BEFORE



AFTER



“There is a serene and settled majesty to woodland scenery that enters into the soul and delights and elevates it, and fills it with noble inclinations.”

Washington Irving



degman
DESIGN·BUILD·REMODEL